



The Sketch Plan of Property Discloses Story in Graphic Form - Entering from Kling Road, the visitor crosses the bridges and ascends the drive way to the house. The drawing shows the position of the garden, garage, cottage and general lay of the land.

Samuel Howe. American Country Houses of To-Day. New York: Architectural Book Publishing, 1915.



TREGARON

Cultural Landscape Report

Cleveland Park, Washington, DC

Client:
TREGARON LIMITED
PARTNERSHIP

Landscape Architect:
HERITAGE LANDSCAPES
Preservation Landscape Architects & Planners
501 Lake Road, Cheshire, VT 05445
802.425.4330
34 Wall Street, Norwalk, CT 06850
203.852.9966

Architect:
MILLER HULL
PARTNERSHIP
71 Columbia 6th Floor
Seattle, WA 98014
206.682.6837

This drawing is the property of HERITAGE
LANDSCAPES and is not to be reproduced or
copied in whole or in part. It is to be returned
upon request.

© HERITAGE LANDSCAPES

Drawing Title:

Platt-Shipman
Sketch Plan 1915

Date:
December 15, 2005

Drawing Number:

1



Original Base:

The Sketch Plan of Property Discloses Story in Graphic Form - Entering from Klinge Road, the visitor crosses the bridges and ascends the drive way to the house. The drawing shows the position of the garden, garage, cottage and general lay of the land.

Samuel Howe. American Country Houses of To-Day. New York: Architectural Book Publishing, 1915.



TREGARON

Cultural Landscape Report

Cleveland Park, Washington, DC

Client:
TREGARON LIMITED
PARTNERSHIP

Landscape Architect:
HERITAGE LANDSCAPES
Preservation Landscape Architects & Planners
501 Lake Road, Cheshire, VT 05445
802.425.4330
34 Wall Street, Norwalk, CT 06850
203.852.9066

Architect:
MILLER HULL
PARTNERSHIP
71 Columbia 6th Floor
Seattle, WA 98014
206.682.6837

This drawing is the property of HERITAGE LANDSCAPES and is not to be reproduced or copied in whole or in part. It is to be returned upon request.

© HERITAGE LANDSCAPES

Drawing Title:
Platt-Shipman
HL Annotated
Sketch Plan 1915

Date:
December 15, 2005

Drawing Number:

2

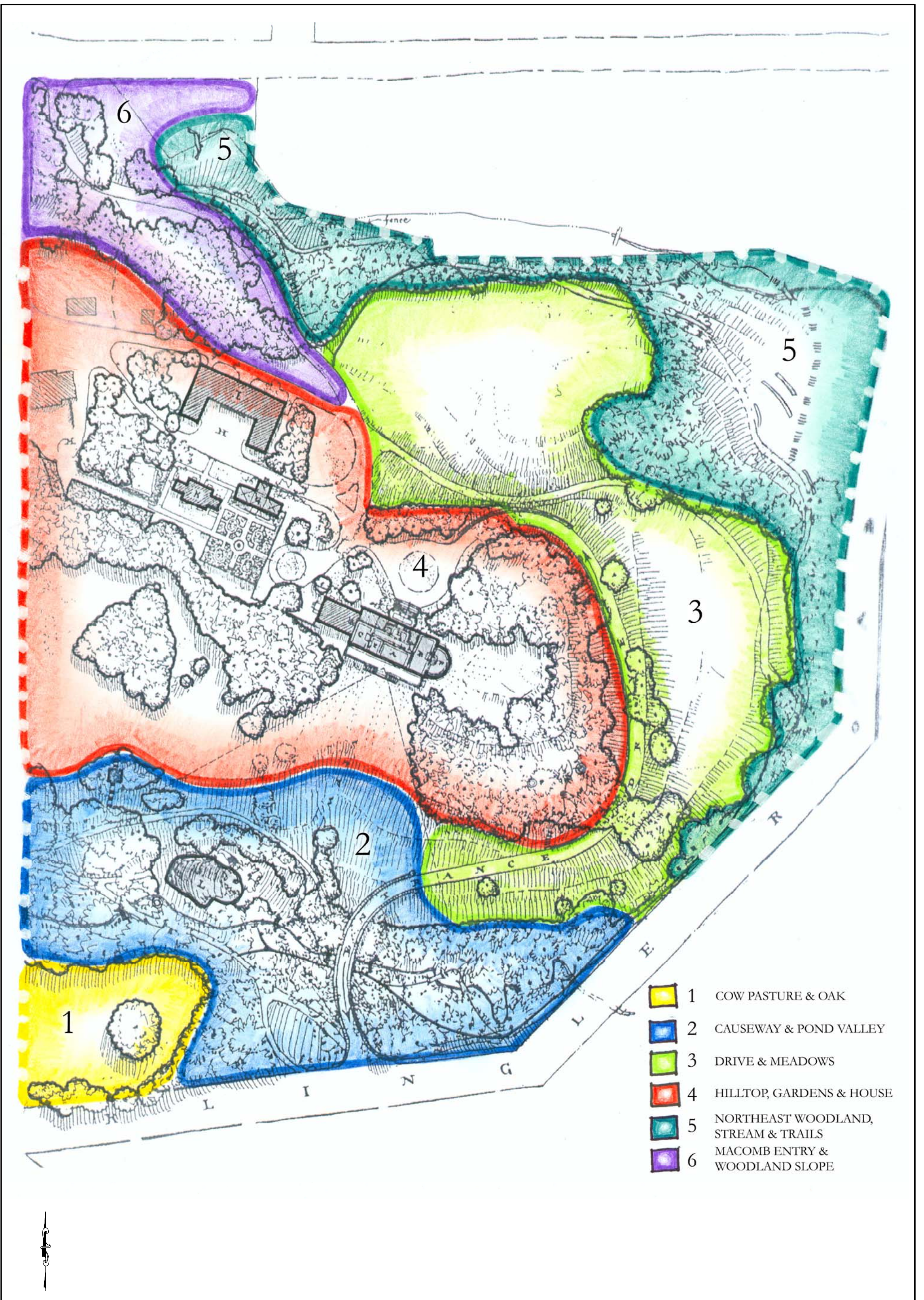

- 1 COW PASTURE & OAK
- 2 CAUSEWAY & POND VALLEY
- 3 DRIVE & MEADOWS
- 4 HILLTOP, GARDENS & HOUSE
- 5 NORTHEAST WOODLAND, STREAM & TRAILS
- 6 MACOMB ENTRY & WOODLAND SLOPE

TREGARON

Cultural Landscape Report

Cleveland Park, Washington, DC



Client:
TREGARON LIMITED PARTNERSHIP

Landscape Architect:
HERITAGE LANDSCAPES PARTNERSHIP
Preservation Landscape Architects & Planners

501 Lake Road, Clarendon, VT 05445
802.425.4330
34 Wall Street, Norwalk, CT 06850
203.852.9966

Architect:
MILLER HULL PARTNERSHIP
71 Columbia, 6th Floor
Seattle, WA 98014
206.482.6837

This drawing is the property of HERITAGE LANDSCAPES and is not to be reproduced or copied in whole or in part. It is to be returned upon request.
© HERITAGE LANDSCAPES

Drawing Title:
Platt-Shipman Era Landscape Units
1915

Date:
December 15, 2005

Drawing Number:
3

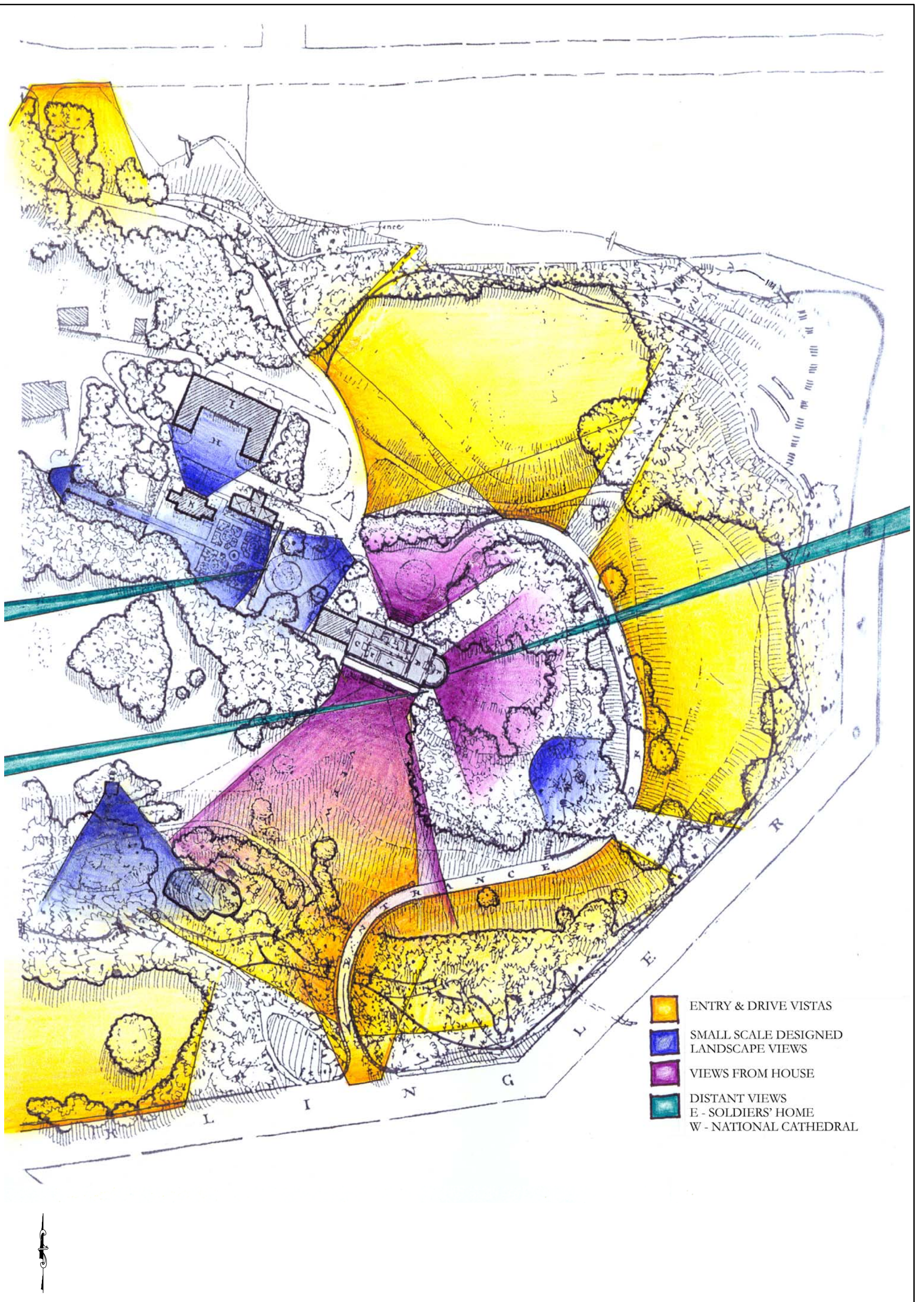

- ENTRY & DRIVE VISTAS
- SMALL SCALE DESIGNED LANDSCAPE VIEWS
- VIEWS FROM HOUSE
- DISTANT VIEWS
E - SOLDIERS' HOME
W - NATIONAL CATHEDRAL

TREGARON

Cultural Landscape Report

Cleveland Park, Washington, DC



Client:
TREGARON LIMITED
PARTNERSHIP

Landscape Architect:
HERITAGE LANDSCAPES
Presentation Landscape Architects & Planners
501 Lake Road, Cheshire, VT 05445
802.425.4330
34 Wall Street, Norwalk, CT 06850
203.852.9066

Architect:
MILLER HULL
PARTNERSHIP
71 Columbia 6th Floor
Seattle, WA 98014
206.682.6837

This drawing is the property of HERITAGE LANDSCAPES and is not to be reproduced or copied in whole or in part. It is to be returned upon request.
© HERITAGE LANDSCAPES

Drawing Title:
Platt-Shipman Era
Visual Relationships

Date:
December 15, 2005

Drawing Number:
4